

# ***SZ650/680/SZ810***

## **SZ Series Stereo Zoom Microscope**



## Outstanding Ergonomic Design

- ◇ SZ680/810 35°viewing angle, SZ650 40°viewing angle, suitable for long-term sitting observation.
- ◇ 330mm×300mm big stand, high stability , apply to all kinds of anatomy of specimen.

## Top Optical & Mechanical Design

- ◇ Greenough optical system, built-in rotating shaft zoom system.
- ◇ No tilting Image in left &right light path in complete pupillary distance , No dizziness feeling after long time observing.
- ◇ (patent number: 201320807246.0)
- ◇ Stereo angle for left & right light path is 12°, stereoscopic effect, large viewing field, high zoom ration.



## Excellent Technology And Quality

- ◇ High resolution, large depth of field, excellent color restoration and contrast.
- ◇ Operation comfortable(manufactured by high-precision machine, excellent assembly technology ).
- ◇ High- end material(PC resin cover, aluminium alloy ,copper alloy parts, austenite stainless steel driving parts).

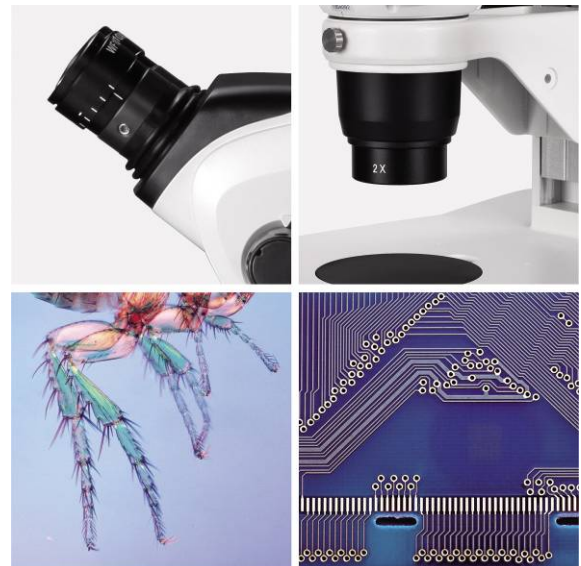

## International Level Appearance Design

- ◇ Elegant shape , high-end and integrated appearance design , comfortable operation.

## Various Accessories,Complete Function.

- ◇ Different video output connectors, built-in digital image model.
- ◇ Illumination optional: LED, halogen lamp, cold light source etc. (100V-240V wide voltage input).
- ◇ Various professional stands and operating attachments.

Photography System

Camera System





SZ650BP



SZ680/810BP



SZ680/810TP



SZ650B2L



SZ680/810B2L



SZ680/810T2L



User can limit the zoom range as per self-choice.



Rotating switching to video output and input, 100% light distribution.



Pillar Stand



Focusing Arm Stand

## Main Technical Specification

| Model                                   | SZ650     | SZ680                 | SZ810      |
|---|-----------|-----------------------|------------|
| Objectives Zoom Range                   | 0.7X-4.5X | 0.68X-4.7X            | 0.65X-5.3X |
| Zoom Ratio                              | 1 : 6.5   | 1 : 6.8               | 1 : 8.1    |
| Field Diameter (mm)                     | Φ22       | Φ23                   | Φ24        |
| Working Distance (mm)                   | 110       | 110                   | 110        |
| Stereo Angle ( ° )                      | 12        | 12                    | 12         |
| Viewing Angle ( ° )                     | 40        | 35                    | 35         |
| Interpupillary Adjustable Distance (mm) | 50-75     | 50-75                 | 50-75      |
| Video Output Distribution               | NO        | 100% (0:100 standard) |            |
|   |           | 50:50 optional        |            |
| Guide Rail Stand Focusing Distance (mm) | 80        |                       |            |
| Pillar Stand Focusing Distance (mm)     | 115       |                       |            |

### SZ650 Series Objective & Eyepiece Parameter List (0.7×-4.5×)

| Additional Objective |                 | 0.5X       | 1X(built-in) | 2X         |
|----------------------|-----------------|------------|--------------|------------|
| W.D                  |                 | 189mm      | 110mm        | 36mm       |
| 10XEyepiece/Φ22mm    | Magnification   | 3.5~22.5   | 7~45         | 14~90      |
|                      | Field dia. (mm) | 62.9~9.8   | 31.43~4.89   | 15.71~2.44 |
| 15XEyepiece/Φ16mm    | Magnification   | 5.25~33.75 | 10.5~67.5    | 21~135     |
|                      | Field dia. (mm) | 45.71~7.11 | 22.86~3.56   | 11.43~1.78 |
| 20XEyepiece/Φ12mm    | Magnification   | 7~45       | 14~90        | 28~180     |
|                      | Field dia.(mm)  | 34.28~5.33 | 17.14~2.67   | 8.57~1.33  |

### SZ680 Series Objective & Eyepiece Parameter List (0.68×-4.7×)

| Additional Objective |                 | 0.5X        | 1X(built-in) | 2X         |
|----------------------|-----------------|-------------|--------------|------------|
| W.D                  |                 | 189mm       | 110mm        | 36mm       |
| 10XEyepiece/Φ23mm    | Magnification   | 3.4~23.5    | 6.8~47       | 13.6~94    |
|                      | Field dia. (mm) | 67.65~9.79  | 33.82~4.89   | 16.91~2.46 |
| 15XEyepiece/Φ16mm    | Magnification   | 5.1~35.25   | 10.2~70.5    | 20.4~141   |
|                      | Field dia. (mm) | 47.06~6.81  | 23.53~3.40   | 11.76~1.70 |
| 20XEyepiece/Φ12mm    | Magnification   | 6.8~47      | 13.6~94      | 27.2~188   |
|                      | Field dia.(mm)  | 35.294~5.11 | 17.65~2.55   | 8.82~1.28  |

### SZ810 Series Objective & Eyepiece Parameter List (0.65×-5.3×)

| Additional Objective |                 | 0.5X       | 1X(built-in) | 2X         |
|----------------------|-----------------|------------|--------------|------------|
| W.D                  |                 | 189mm      | 110mm        | 36mm       |
| 10XEyepiece/Φ24mm    | Magnification   | 3.3~25.5   | 6.6~51       | 13.2~102   |
|                      | Field dia. (mm) | 72.73~9.41 | 36.36~4.71   | 18.18~2.35 |
| 15XEyepiece/Φ16mm    | Magnification   | 4.95~38.25 | 9.9~76.5     | 19.8~153   |
|                      | Field dia. (mm) | 48.48~6.27 | 24.24~3.14   | 12.12~1.57 |
| 20XEyepiece/Φ12mm    | Magnification   | 6.6~51     | 13.2~102     | 26.4~204   |
|                      | Field dia. (mm) | 39.64~4.71 | 18.18~2.35   | 9.09~1.18  |

# SZ650/680/810 Series Zoom Stereo Microscope General Layout Diagram

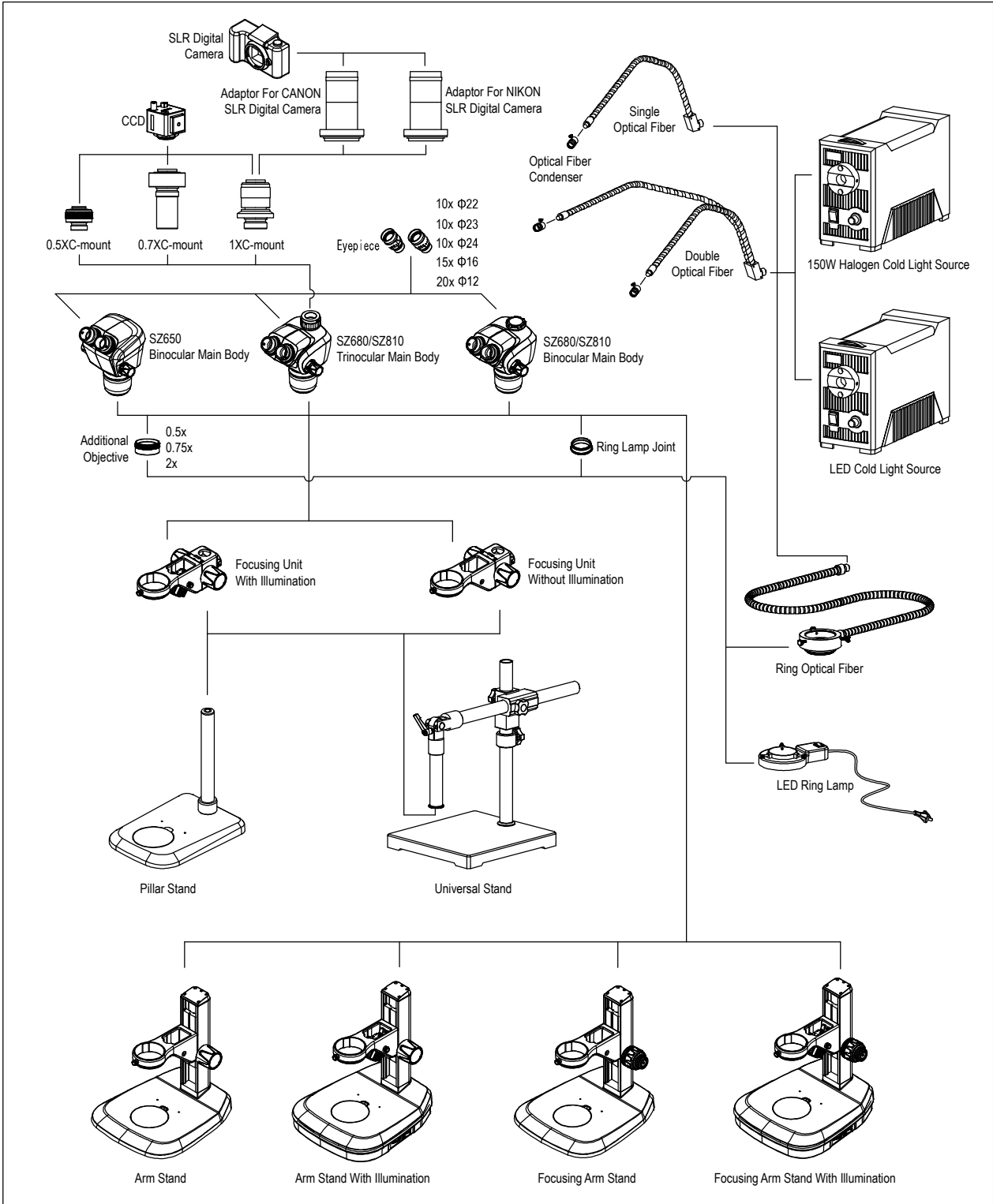

### SZ650/680/810 Series Zoom Stereo Microscope Outfit

| Items                   |            | SZ650BP | SZ650B2L | SZ680BP | SZ680B2L | SZ810BP | SZ810B2L |
|-------------------------|------------|---------|----------|---------|----------|---------|----------|
| Main Body               | Binocular  | ●       | ●        | ●       | ●        | ●       | ●        |
|                         | Trinocular |         |          | ○       | ○        | ○       | ○        |
| 10XEyepiece/Φ22mm       |            | ●●      | ●●       |         |          |         |          |
| 10XEyepiece/Φ23mm       |            |         |          | ●●      | ●●       |         |          |
| 10XEyepiece/Φ24mm       |            |         |          |         |          | ●●      | ●●       |
| 15XEyepiece/Φ16 mm      |            | ○○      | ○○       | ○○      | ○○       | ○○      | ○○       |
| 20XEyepiece/Φ12mm       |            | ○○      | ○○       | ○○      | ○○       | ○○      | ○○       |
| 0.5X/0.75X/2X Objective |            | ○       | ○        | ○       | ○        | ○       | ○        |
| Focusing unit           |            | ●       | ●        | ●       | ●        | ●       | ●        |
| No light                |            | ●       |          | ●       |          | ●       |          |
| Reflecting 3W LED       |            |         | ●        |         | ●        |         | ●        |
| Transmitting 3W LED     |            |         | ●        |         | ●        |         | ●        |
| Black & white Plate     |            | ●       | ●        | ●       | ●        | ●       | ●        |
| Glass Plate             |            |         | ●        |         | ●        |         | ●        |
| Arm stand               |            | ●       | ●        | ●       | ●        | ●       | ●        |
| Pillar stand            |            | ○       | ○        | ○       | ○        | ○       | ○        |
| Focusing Arm stand      |            | ○       | ○        | ○       | ○        | ○       | ○        |
| Base (330×300mm)        |            | ●       | ●        | ●       | ●        | ●       | ●        |
| C-mount 0.5X, 0.7X, 1X  |            |         |          | ○       | ○        | ○       | ○        |

Note: "●" In Table Is Standard Outfits, "○" Is Optional Accessories.

### SZ650/680/810 Series Zoom Stereo Microscope Size(mm)

